



416 Travis Street, Suite 1401  
Shreveport, LA 71101

JEREMY HARRIS, CPL

TOBY J. HARGRAVE

September 25, 2024

Mr. Malcolm Stadtlander  
City of Shreveport, Louisiana  
505 Travis Street, Suite 200  
Shreveport, Louisiana 71107

**Re: Nomination of City of Shreveport Mineral Acreage for Oil, Gas, and Mineral Lease in Sections 19 & 30, T17N-R14W and Sections 28 & 33, T17N-R14W, Caddo Parish, Louisiana**

Dear Mr. Stadtlander,

I am writing on behalf of Cypress Energy Partners, LLC (hereinafter "CEP") to express our interest in acquiring an Oil, Gas, and Mineral Lease from the City of Shreveport (hereinafter "COS"). The lease pertains to approximately 58.7608 gross acres and 58.7608 net acres, more or less, located in Sections 19 & 30, T17N-R14W and Sections 28 & 33, T17N-R14W, Caddo Parish, Louisiana.

CEP proposes a lease with the minimum terms being \$3,000 per acre and 25% royalty. We recognize that the COS will need to review our proposal and issue a Resolution authorizing the State Mineral Board of Louisiana ("Mineral Board") to act on its behalf during an upcoming Louisiana State Agency Lease Sale.

CEP respectfully requests that our lease proposal be included on the agenda for consideration at the next COS Council Meeting. We seek the COS's authorization of a Resolution granting the Mineral Board the authority to lease the aforementioned lands on behalf of the COS.

Should the COS agree to grant the requested Resolution, we will promptly deliver it, along with all required documents and applications, to the Office of Mineral Resources upon receipt.

Thank you for your attention to this matter.

Yours sincerely,

**CYPRESS ENERGY PARTNERS, LLC**

*Nick Palmer*

Nick Palmer  
Agent for Cypress Energy Partners, LLC

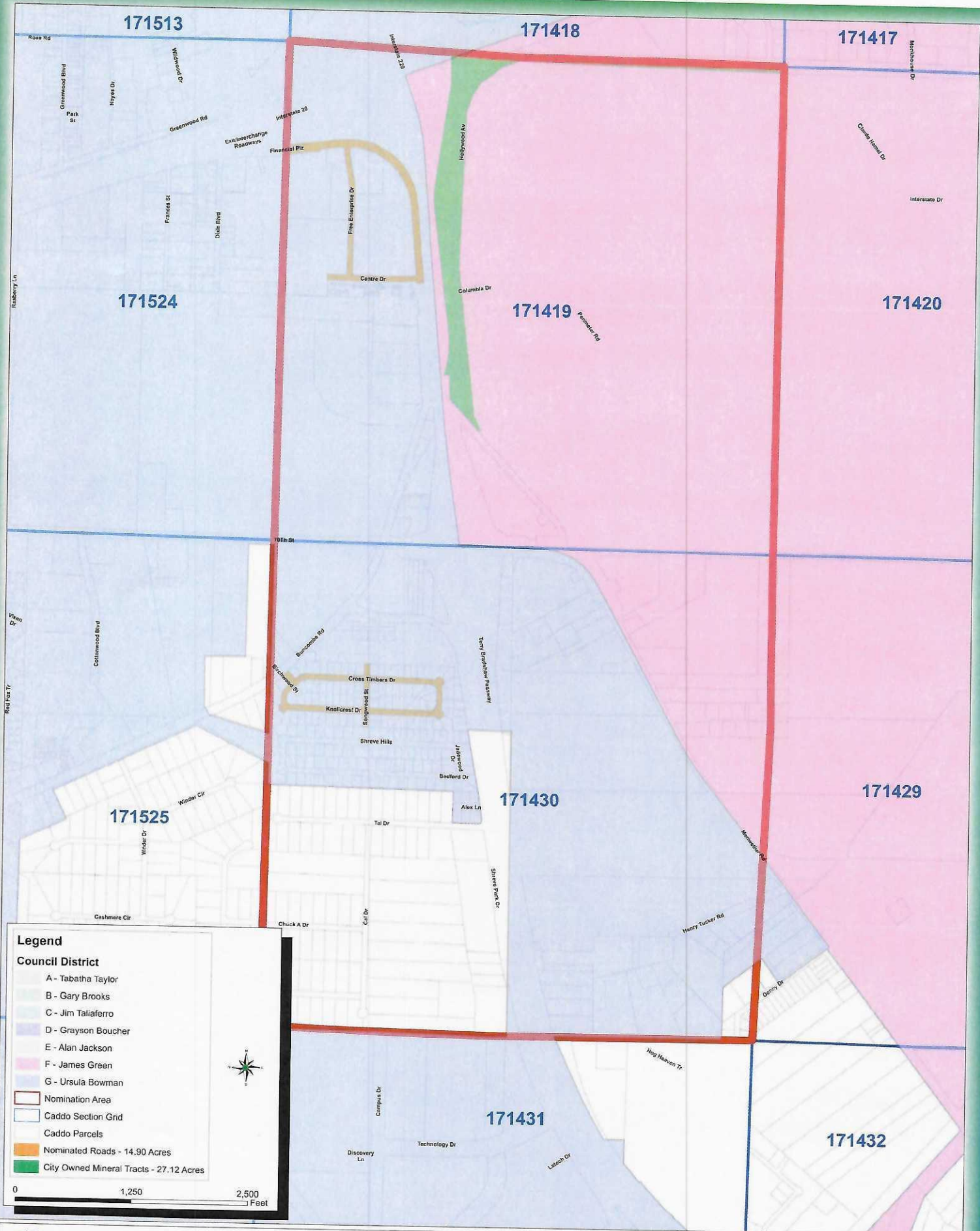

# City of Shreveport

Mineral Ownership in Sections 19 & 30 (T17N - R14W) - 42.02 Total Acres



Copyright 2024. The City of Shreveport assumes no responsibility or legal liability for the accuracy, completeness, reliability, timeliness, or usefulness of any information available on this map. The location of any displayed infrastructure may not be accurate or correct and should be verified prior to any planning, design, construction, etc.



